

REVISION		
No	DESCRIPTION	DATE
A	revision	20.03.13
B	revision	27.03.13
C	revision	22.05.13

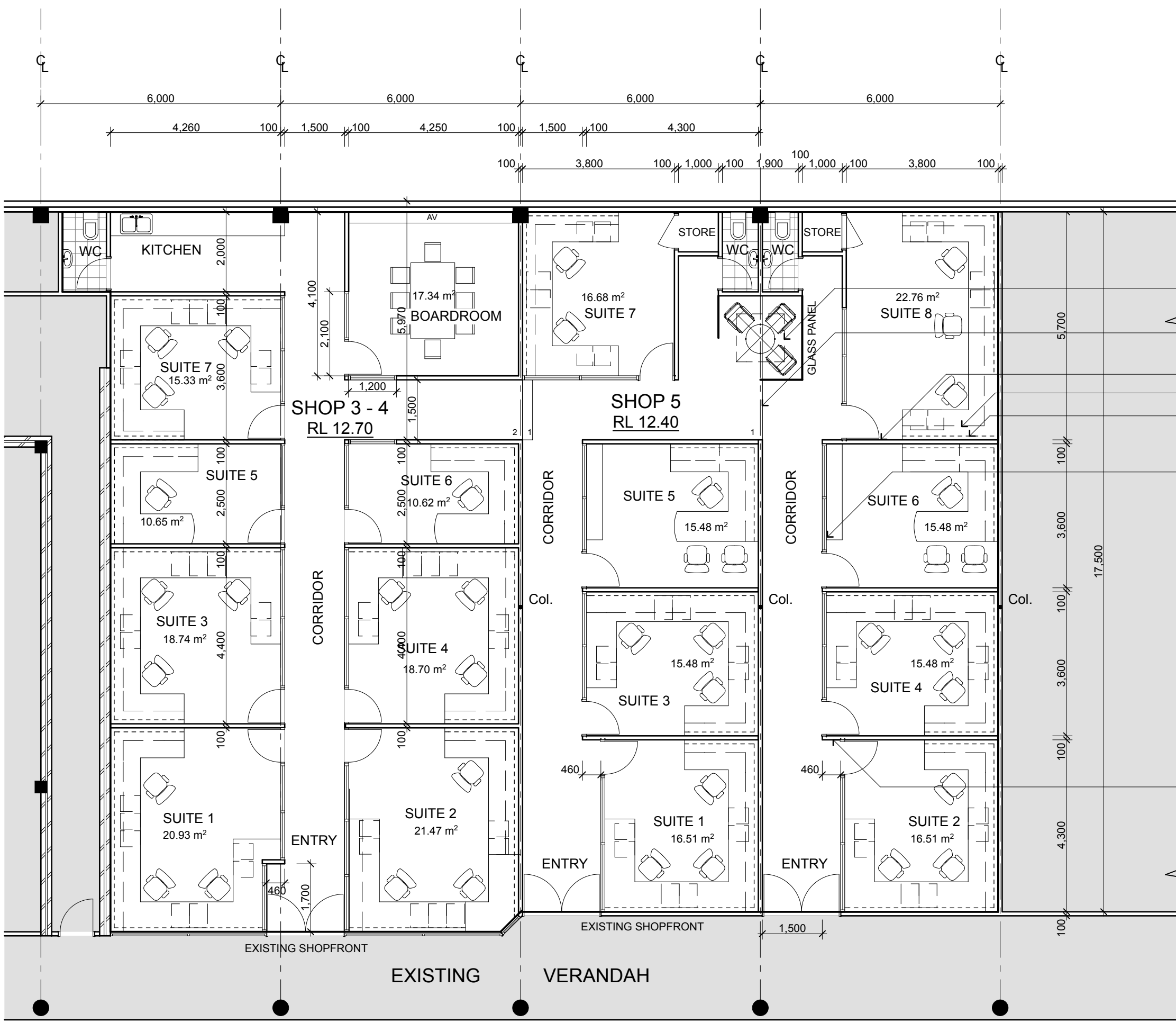

- "VERTEX" - FCM4646 FLAT ROOF HIGH PERFORMANCE DOUBLE GLAZING SKYLIGHT OVER SEATING AREA
- STEP 150mm RISE
- STUD FRAME AND GYPSUM WALL
- OVERHEAD SHELVING
- WORKSTATION PINBOARD
- COMMERCIAL OFFICE INTERNAL GLAZING AS MANUFACTURER'S DESIGN AND SPECIFICATION

- NOTE**
1. THE BUILDER / OWNER IS RESPONSIBLE FOR CHECKING EACH DRAWING AS PROVIDED PRIOR TO ISSUING FOR APPROVAL / CONSTRUCTION. THE UNDERTAKING OF ANY CONSTRUCTION WORK SHALL DEEM THAT THE BUILDER / OWNER HAVE VERIFIED THE PLANS AS CORRECT AND SUITABLE FOR CONSTRUCTION
 2. DO NOT SCALE DRAWINGS. VERIFY ALL DIMENSIONS ON SITE AT ALL TIME BEFORE COMMENCING ANY WORK.
 3. FOR ANY DISCREPANCY ANOMALY ON THE DRAWING PLEASE CONTACT ENZHUO STUDIO / JASON GAI IMMEDIATELY.
 4. ALL DIMENSION & COLUMN LOCATION ARE INDICATIVE ONLY. IT REQUIRES CONFIRMATION ON SITE BEFORE COMMENCING ANY WORK.
 5. THIS DRAWING AND THE CONTENTS THEREIN ARE THE SUBJECT OF COPYRIGHT AND SHALL NOT BE COPY OR REPRODUCED IN PART OR IN WHOLE WITHOUT WRITTEN PERMISSION.

ENZHUO STUDIO | building design + interior |
 Suite 2.08, Level 2, 4 Ilya Ave, Erina N.S.W. 2250
 mobile: 0416 031 668 email: enzhuo@live.com.au
 web: enzhuostudio.wordpress.com
 Enzhuo Jason Gai, bachelor of design (architecture)

client : Commercial HQ
 project : Shop 3-5
 131-135 Henry Parry Dr
 Gosford
 job No. : 0670_revC
 drawing : Ground Plan
 scale : 1 : 100 @ A3
 date : 22/05/2013

1 Ground
 1:100