

Statement of Information

Single residential property located outside the Melbourne metropolitan area

Section 47AF of the Estate Agents Act 1980

Property offered for sale

Address
Including suburb or
locality and postcode

35 Little Yarra Road, Yarra Junction Vic 3797

Indicative selling price

For the meaning of this price see consumer.vic.gov.au/underquoting

Range between

\$250,000

&

\$275,000

Median sale price

Median price

\$600,000

House

X

Unit

Suburb or locality

Yarra Junction

Period - From

01/10/2017

to

31/12/2017

Source

REIV

Comparable property sales (*Delete A or B below as applicable)

~~A* These are the three properties sold within five kilometres of the property for sale in the last eighteen months that the estate agent or agent's representative considers to be most comparable to the property for sale.~~

Address of comparable property	Price	Date of sale
1		
2		
3		

OR

B* The estate agent or agent's representative reasonably believes that fewer than three comparable properties were sold within five kilometres of the property for sale in the last eighteen months.

Tony Fanfulla
03 5967 1277
0419 870 513
tony@bellrealestate.com.au

Indicative Selling Price
\$250,000 - \$275,000
Median House Price
December quarter 2017: \$600,000

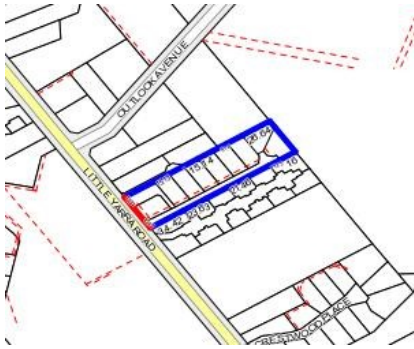

Rooms:
Property Type: House (Previously Occupied - Detached)
Land Size: 6070 sqm approx
Agent Comments

Comparable Properties

The estate agent or agent's representative reasonably believes that fewer than three comparable properties were sold within five kilometres of the property for sale in the last eighteen months.