

Statement of Information

Single residential property located in the Melbourne metropolitan area

Section 47AF of the Estate Agents Act 1980

Property offered for sale

Address Including suburb and postcode 13 Christopher Crescent, Tullamarine Vic 3043

Indicative selling price

For the meaning of this price see consumer.vic.gov.au/underquoting

Single price \$690,000

Median sale price

Median price \$655,500 House X Unit Suburb Tullamarine

Period - From 01/04/2017 to 30/06/2017 Source REIV

Comparable property sales (*Delete A or B below as applicable)

A* These are the three properties sold within two kilometres of the property for sale in the last six months that the estate agent or agent's representative considers to be most comparable to the property for sale.

	Address of comparable property	Price	Date of sale
1	1 Churchill Av TULLAMARINE 3043	\$641,000	18/03/2017
2	73 Churchill Av TULLAMARINE 3043	\$635,000	08/06/2017
3	8 Christopher Cr TULLAMARINE 3043	\$609,000	18/03/2017

OR

B* The estate agent or agent's representative reasonably believes that fewer than three comparable properties were sold within two kilometres of the property for sale in the last six months.

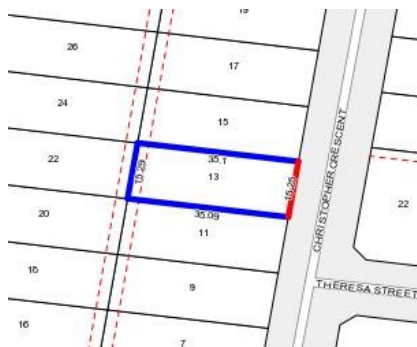

Rooms:
Property Type: House (Res)
Agent Comments

Indicative Selling Price
 \$690,000
Median House Price
 June quarter 2017: \$655,500

Comparable Properties



1 Churchill Av TULLAMARINE 3043 (REI)

Agent Comments



Price: \$641,000
Method: Auction Sale
Date: 18/03/2017
Rooms: 4
Property Type: House (Res)
Land Size: 534 sqm approx



73 Churchill Av TULLAMARINE 3043 (REI)

Agent Comments



Price: \$635,000
Method: Private Sale
Date: 08/06/2017
Rooms: 4
Property Type: House
Land Size: 582 sqm approx



8 Christopher Cr TULLAMARINE 3043 (REI)

Agent Comments



Price: \$609,000
Method: Auction Sale
Date: 18/03/2017
Rooms: 5
Property Type: House (Res)
Land Size: 550 sqm approx