

WALL	CLASH/CREAM
ROOF	CLASH/CREAM
GLASS	CLASH/CREAM
WOOD	CLASH/CREAM
CONCRETE	CLASH/CREAM
ASPH/FLT	CLASH/CREAM
ASPH/FLT	CLASH/CREAM
ASPH/FLT	CLASH/CREAM

- LIGHTING TO BOTH GROUND FLOOR & FIRST FLOOR
- HI-BAY LIGHTING TO BOTH WAREHOUSE AREAS
- EXCLUDE KERBING TO CARPARK

- VALUANI SANDY
- GRASS WITH WHITE
- PROPOSED LANDSCAPE
- WHITE GREEN LEAF COVER

SEWER CONNECTION POSITION
 APPROXIMATE ONLY
 SEWER INVERT LEVEL 25.8
 SEWER BROUGHT UP 1.2
 DEPTH TO CONNECTION 0.6

NOTE:
 ABB171

HYDRANT APPROX 94.5m FROM BODY
 HYDRANT APPROX 19.0m FROM BODY
 DATUM NAL 27.39 APPROX. AHD

DATA SHEET	
SITE AREA:	157.00
BUILDING AREA:	17.00
PLANT ROOM:	0.00
LANDSCAPE PROVIDED:	1m
PARKING REQUIRED:	6.15
PARKING PROVIDED:	6
VERGE AREA:	0.00

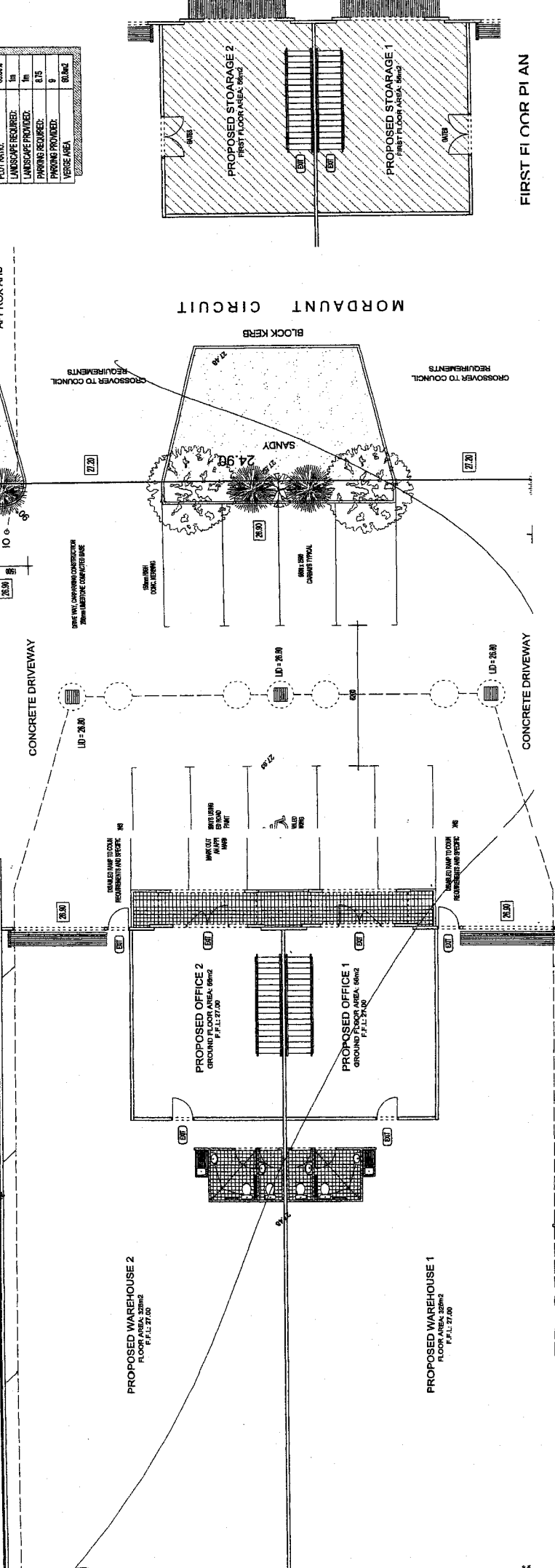

FIRST FLOOR PLAN