



SPACE + CONVENIENCE

135 Nancy Ellis Leebold Drive, Bankstown



an ideal location situated adjacent to Bankstown Airport+

Situated on Nancy Ellis Leebold Drive, this unique facility is located just under 2km from Bankstown Airport and only 7.5km from the M5 Motorway.

02

135 Nancy Ellis
Leebold Drive,
Bankstown



2km

to Bankstown Airport



7.5km

to M5 Motorway



17km

to Parramatta CBD



1.4km

to Milperra Road



8km

to Hume Highway



Nancy Ellis Leebold Drive

To Milperra Road

135 Nancy Ellis Leebold Drive, Bankstown

Bankstown Airport

03

135 Nancy Ellis Leebold Drive, Bankstown



04

135 Nancy Ellis
Leebold Drive,
Bankstown

features+

- + 5,714 sqm of warehouse and 454 sqm office space
- + Cross dock facility with generous loading areas and drive around access
- + 60 roller shutter doors
- + 9 dock levellers
- + Minimum 9.4m and maximum 12.1m warehouse clearance
- + Awning space of 1,623 sqm
- + Onsite parking for staff and visitors



OVERVIEW

site plan

05

135 Nancy Ellis
Leebold Drive,
Bankstown

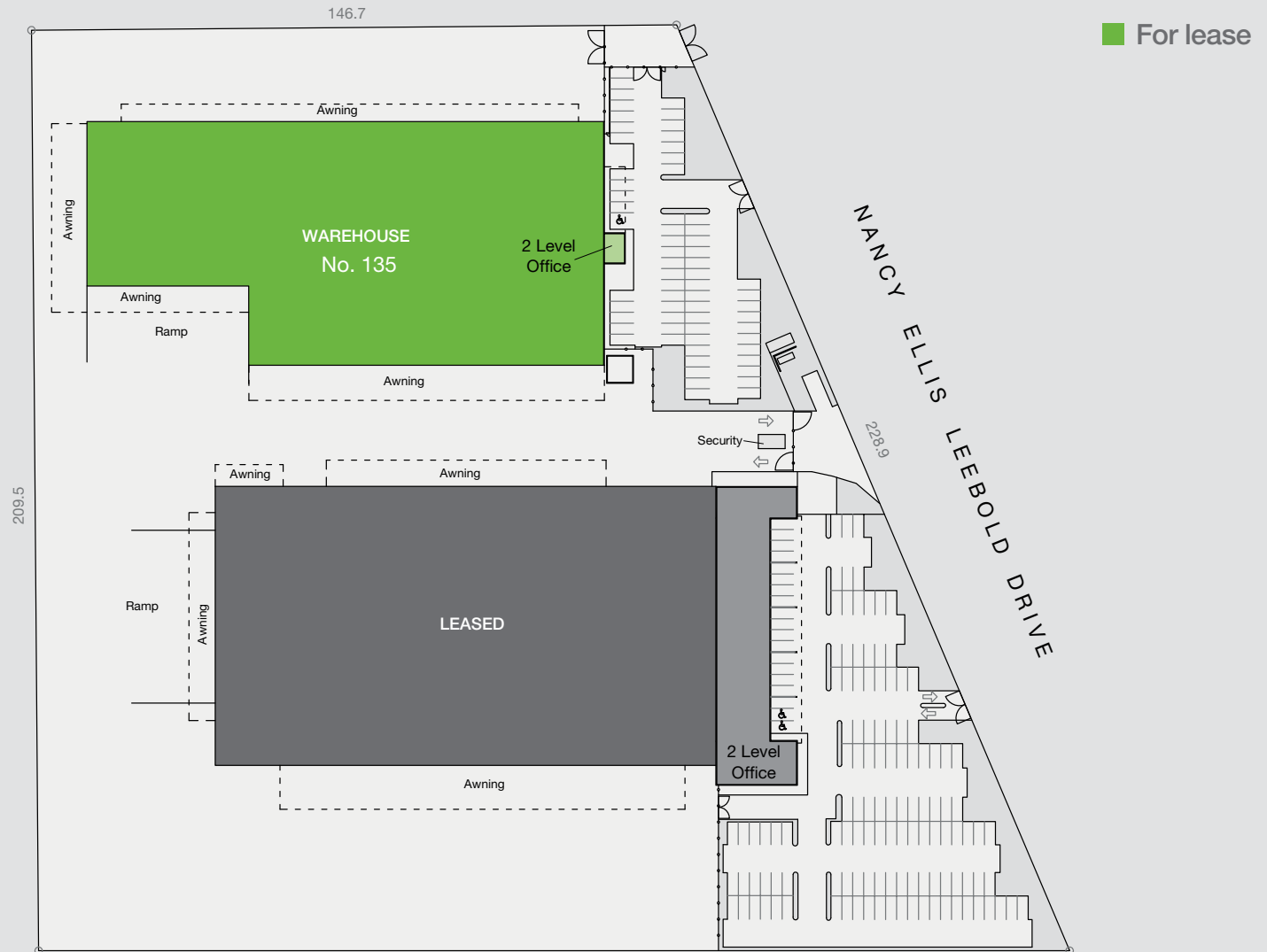

building plan

06

135 Nancy Ellis
Leebold Drive,
Bankstown

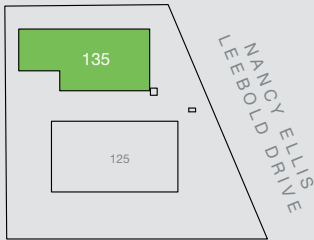
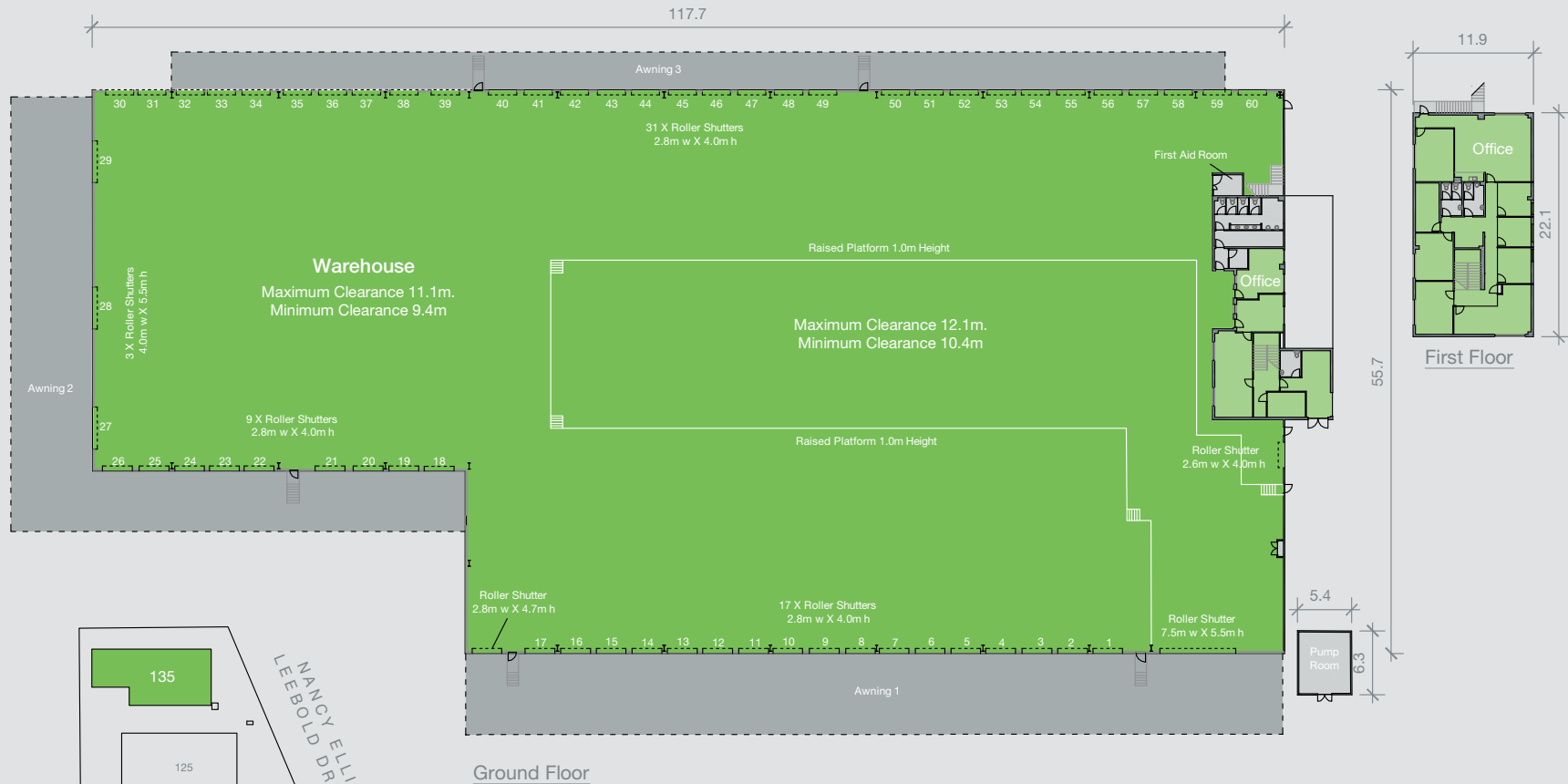

LOCATION PLAN
NOT TO SCALE

Area schedule	sqm
Warehouse	5,714.0
Office and amenities	174.5
First floor office	273.0
Total	6,161.5

07

135 Nancy Ellis
Leebold Drive,
Bankstown



contact+

Jamie Wiener
Portfolio Manager

T 02 9230 7167
M 0411 494 920
jamie.wiener@goodman.com

Felicity Quinn
Asset Manager

T 02 9230 7206
M 0410 346 903
felicity.quinn@goodman.com

Goodman
Level 17
60 Castlereagh Street
Sydney NSW 2000
T 02 9230 7400

www.goodman.com



www.goodman-better-business.com

This document has been prepared by Goodman Property Services (Aust) Pty Ltd ABN 40 088 981 793 for general information purposes only. Whilst every care has been taken in relation to its accuracy, no warranty of accuracy is given or implied. You should obtain your own independent advice before making any decisions about the property referred to in this document. Images contained in this document have been used to enable the customer to visualise the development concepts only, and are not intended to definitively represent the final product.
November 2013